



**3 Bed
House - Terraced
located in Upton**

Offers in the region of
£170,000



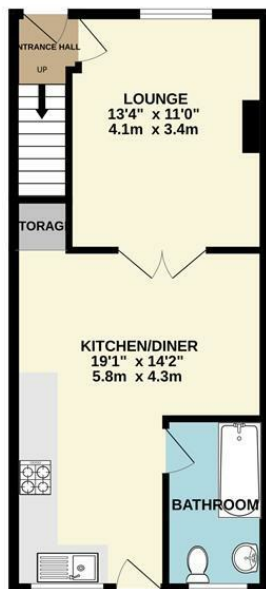

BURROWS
Residential

GROUND FLOOR
633 sq.ft. (58.8 sq.m.) approx.

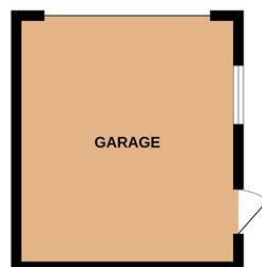
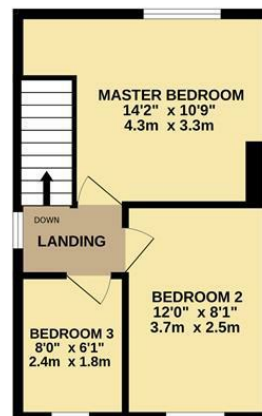

1ST FLOOR
318 sq.ft. (29.6 sq.m.) approx.



TOTAL FLOOR AREA: 951 sq.ft. (88.4 sq.m.) approx.

Whilst every attempt has been made to ensure the accuracy of the floorplan contained here, measurements of doors, windows, rooms and any other items are approximate and no responsibility is taken for any error, omission or mis-statement. This plan is for illustrative purposes only and should be used as such by any prospective purchaser. The services, systems and appliances shown have not been tested and no guarantee as to their operability or efficiency can be given.
Made with Metropix ©2026

Energy Efficiency Rating		
	Current	Potential
Very energy efficient - lower running costs		
(92 plus) A		
(81-91) B		
(69-80) C		
(55-68) D		
(39-54) E		
(21-38) F		
(1-20) G		
Not energy efficient - higher running costs		
England & Wales		EU Directive 2002/91/EC

DIRECTIONS

CONTACT

Unit 6
Century 2 Business Centre 3 Dearne Lane
Manvers
Rotherham

E: info@burrowsresidential.co.uk
T: 07507 905644

